

ASSEMBLY INSTRUCTIONS FOR DL800SQ

July 2013

The DL800SQ is a frameless counter top glass cabinet with double hinged doors, adjustable shelves and built-in lights.

The box contains all the parts necessary for its assembly including tools.

ASSEMBLY

Assembly of the DL800SQ is by way of poles, brackets, screws (nuts) and bolts.

In the main, the cabinet should be assembled upright rather than lying down.

One person can assemble the cabinet, but it can be helpful to have a second person for various tasks.

It is easier to clean the glass before, or at least during, assembly.

Occasionally, the parts diagram may differ from the contents of the box. Design improvements mean that your cabinet may differ in certain respects from what is described in these instructions.

1. After unpacking the boxes, place the wooden base on the ground.
2. The cabinet is mainly held together by the four poles supplied. In combination with the glass sides and the brackets, these poles give the cabinet structural integrity. They also support the shelves, and two of the four poles hold the lights.
3. A total of four poles have been supplied. Two of these four poles are plain, i.e. they have no light fittings on them, while the other two have light fittings attached and wires coming from the base of them.
4. Install the poles first. The poles should be inserted through the holes in the base, and secured with either the long screws or bolts supplied, as appropriate. Remember to use a washer. See Photos 1 and 2.
5. The poles with light fittings go at the front of the cabinet, nearest to the wiring under the base. The wires from the two light poles must be wired into the connector blocks under the base using the small red screwdriver supplied. Before doing so, however, ensure a flange (collar) is placed on the pole, as shown in Photo 4.



SHOWCASESDIRECT
design strength value

Ph: 027 2937193
Fax: (09) 6290900
Email: info@showcasesdirect.co.nz
www.showcasesdirect.co.nz

6. The wiring required is shown in Photo 3.



SHOWCASESDIRECT
design strength value

Ph: 027 2937193
Fax: (09) 6290900
Email: info@showcasesdirect.co.nz
www.showcasesdirect.co.nz

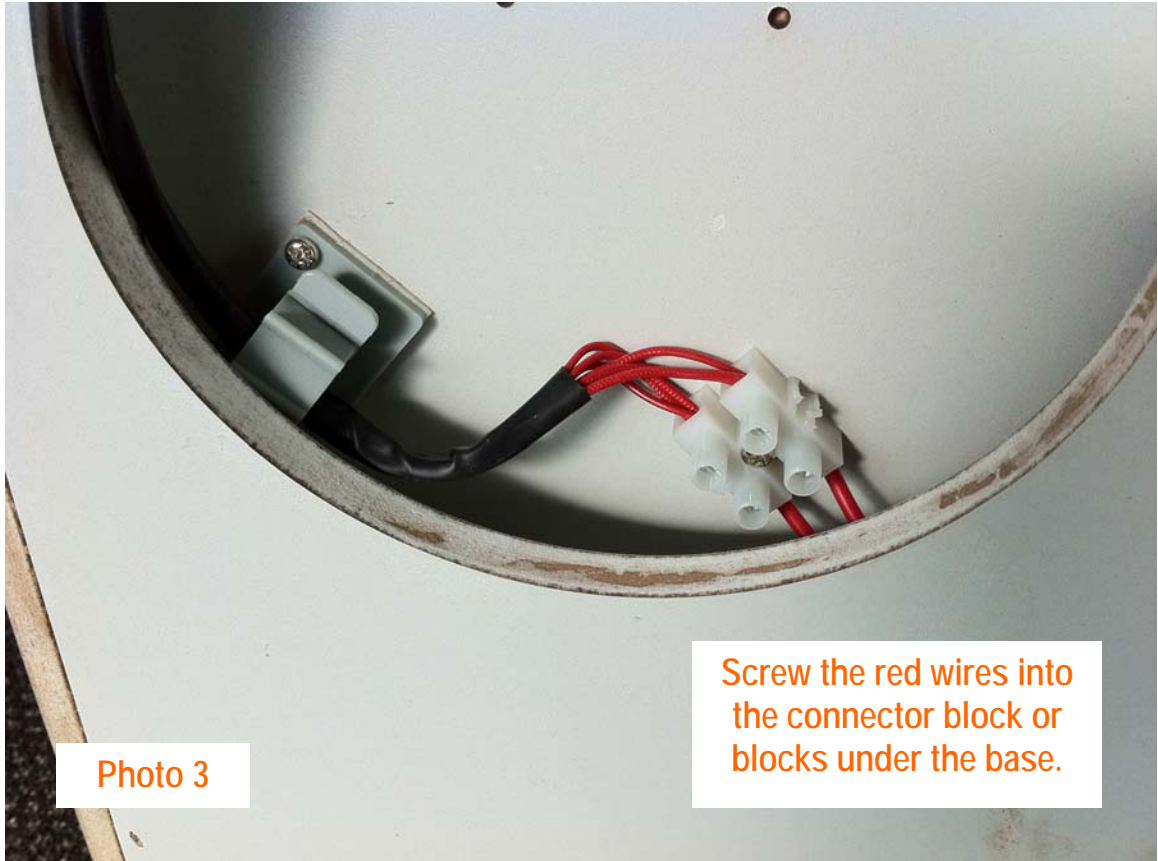
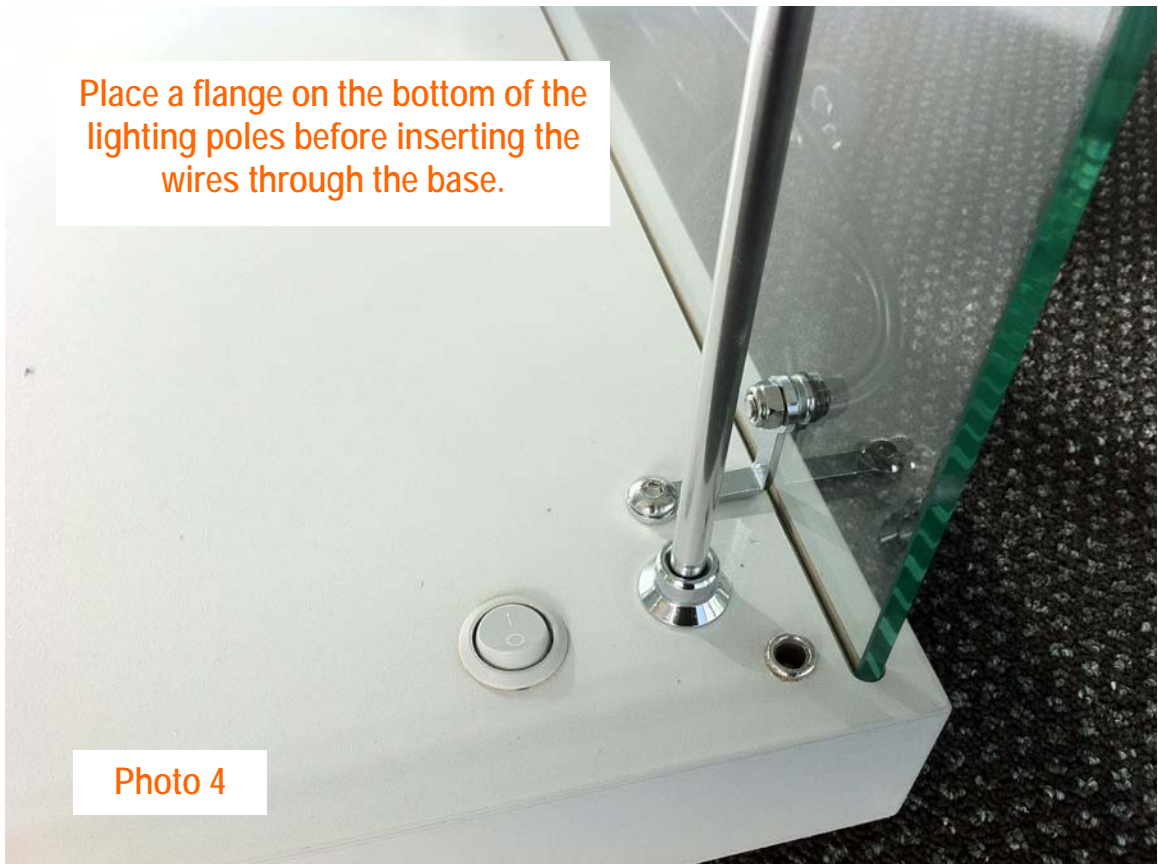

Photo 3

Screw the red wires into the connector block or blocks under the base.



Place a flange on the bottom of the lighting poles before inserting the wires through the base.

Photo 4



SHOWCASESDIRECT
design strength value

Ph: 027 2937193
Fax: (09) 6290900
Email: info@showcasesdirect.co.nz
www.showcasesdirect.co.nz

7. After all four poles have been secured in place, place the cabinet upright. The shelf supports and flanges can be threaded on to the rear poles (the ones with no light fittings). The flanges are designed to cover the hole that the poles go through – see Photo 5. The shelf supports are placed on to the pole with the rubber pad facing upwards. Each pole will have one flange (which goes on first), followed by two shelf supports.

NOTE: The poles with light fittings on them already have their shelf supports pre-threaded (in-between the light fittings). You should have already threaded the bottom flange on (before poking the wires through the base).



8. Take the back glass panel (the largest of the glass panels), and place it in the appropriate slot on the base board. There is a right and wrong side up. You can tell which end goes in the base by the holes on this side being slightly further from the edge than the holes on the other end. This extra distance is to accommodate the groove in the base the panel sits in.
9. Place one of the side panels into its slot on the base board, at right angles to the back panel. Fasten the two panels together at the top corner using a three-way bracket and two screws (see Photo 6). Repeat this process with the second side panel. Fix them together at the base using a 2-way bracket (Photo 5).



10. Once the poles, the sides and the shelf supports have been put in place, the top can be fixed in place. In the rear corners, the top is fixed by a screw that goes through the 3-way bracket and into the rear pole. See Photo 6. At the front corners, the same principle is used but the 2-way bracket used to hold the top down incorporates the door hinge (see Photo 8).



11. Fit the doors. The hinges that go at the bottom of the doors are standard clamp hinges, but the hinges at the top of the doors incorporate the top 2-way bracket. For both, the hinges supplied have two screws on one side, and double sided adhesive foam on the other. The screws are designed to face the back of the cabinet once the doors are in place, so they must be fitted in pairs to achieve this effect. It is not recommended to have the screws facing outwards, where they can be seen. Remove the yellow (or white) waxed paper from the adhesive foam which is already in place on the inside of the hinge. Place the hinge on a corner of one of the doors, and allow the adhesive foam to hold it in place. The doors and hinges are designed to have approximately 1mm margin between the edge of the hinge and the edge of the door. See Photo x. Place one of the supplied pieces of flat metal between the screws on the other side of the hinge and the glass i.e. **DO NOT SCREW DIRECTLY ONTO THE GLASS OR YOU RISK BREAKING IT.** In no circumstances should the screws make contact with the glass. Tighten the screws in tandem until they hold the hinge in place - the screws should be tightened reasonable firmly.
12. Repeat this process for the other hinge, and the other door, ensuring the hinges are placed as pairs with the screws facing the same way. See Photos 7 and 8.



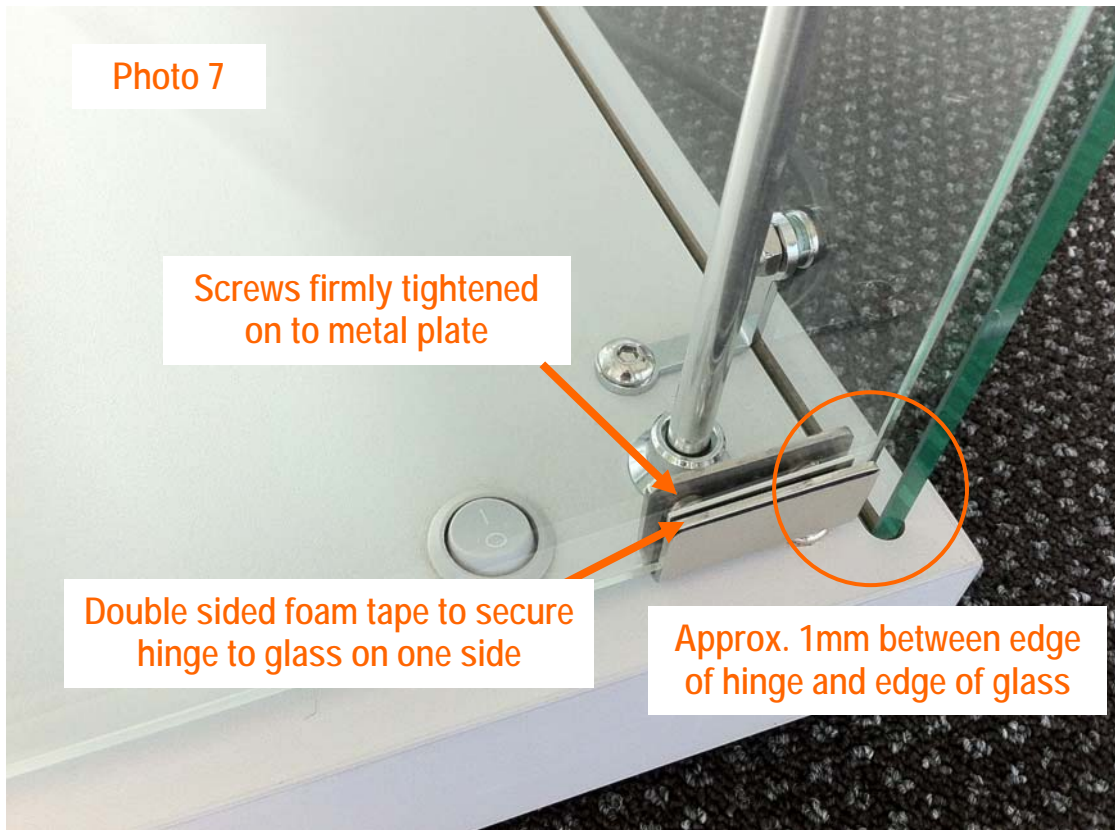

SHOWCASESDIRECT
design strength value

Ph: 027 2937193
Fax: (09) 6290900
Email: info@showcasesdirect.co.nz
www.showcasesdirect.co.nz

13. Place the doors with the hinges attached in the relevant holes in the base, and lift the top until you can slide the hinge over the front poles. Fix the top hinge in place, as shown in photo x.
14. Place the lock in the appropriate position on the door, and tighten with the supplied screwdriver.
15. Put the shelves in place. You can place the shelves at any height, as they are fully adjustable between the light fittings (which are not adjustable). The important thing is to ensure that each of the four shelf supports are at exactly the same height so that the shelf is level. This involves measuring the height of shelf support as you position them. Start with the bottom shelf and work your way up. Tighten the shelf supports firmly into place with the small Phillips screw driver supplied – the small screws should be fastened securely onto the pole. Place each shelf into the shelf supports in turn.
16. If it is not pre-fitted, screw the door stoppers into the pre-drilled hole in the top.



SHOWCASESDIRECT
design strength value

Ph: 027 2937193
Fax: (09) 6290900
Email: info@showcasesdirect.co.nz
www.showcasesdirect.co.nz